

Date: 2023-11-23
 Enquiry dated:
 Project:
 Quotation-no.:
 Item:
 Reference:



Evaporator (dx) GHF 045.2H/47-ANW50.E For calculation only!

Capacity:	32.9 kW ⁽¹⁾	Refrigerant:	R134a ⁽²⁾
Surface reserve:	1.1 %	Evaporation temp.:	-8.0 °C
Air flow:	20560 m ³ /h	Superheating:	5.0 K
Air inlet:	0.0 °C	Condensing temp.:	35.0 °C
Air outlet:	-3.8 °C	Subcooled temp.:	30.0 °C
Air pressure:	1013 mbar		

Fans:	4 Piece(s) 1~230V 50Hz	Noise pressure level:	61 dB(A) in 3.0 m ⁽³⁾
Data per motor (nominal data):		Noise power level:	84 dB(A)
Speed:	1360 min-1	Air throw:	approx. 44 m ⁽⁴⁾
Capacity (mech./el.):	0.30 kW/0.47 kW	Frost:	0.0 mm
Current:	2.20 A ⁽⁵⁾		
ErP:	Compliant ⁽⁶⁾		

Total el. power consumption:	1.96 kW	Energy efficiency class:	D (2014)
------------------------------	---------	--------------------------	----------

Casing:	AlMg, Powder coated RAL 9003	Tubes:	Copper ⁽⁷⁾
Surface:	123.0 m ²	Fins:	Aluminum ⁽⁷⁾
Tube volume:	41.0 l	Distr. press. drop:	1.1 bar
Fin spacing:	7.00 mm	Outlet connection:	54.0 * 2.00 mm
Dry weight:	222 kg ⁽⁸⁾	Inlet connection:	22.0 mm
Max. operating pressure:	32.0 bar	PED classification:	Category I, module A ⁽⁹⁾

- Dimensions:**
- L = 4130 mm
 - B = 660 mm
 - H = 650 mm
 - E = 890 mm
 - F = 545 mm
 - C = 290 mm
 - A = 500 mm
 - ØD = 11 mm
 - K = G1¼

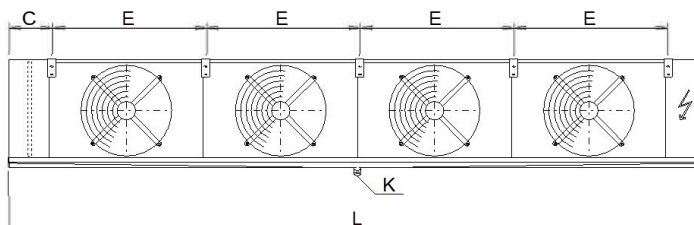
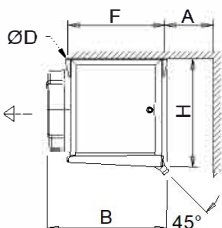

Drain according to DIN ISO 228-1 with G-thread (flat gasket).
 Attention: Drawing and dimensions not valid for all accessory options!